



Advanced Card Systems Ltd.
Card & Reader Technologies

ACS SmartAccess (for iOS)



User Guide V1.00



Table of Contents

1.0.	Introduction	3
2.0.	For iOS	4



1.0. Introduction

ACS SmartAccess is an application that demonstrates Access Control usage for ACS Bluetooth Readers. To fully access the application's features, connect an ACS Bluetooth Reader and use with a smart card.

Supported smart card readers are **ACR3901U-S1 Secure Bluetooth Contact Card Reader** and **ACR1255U-J1 Secure Bluetooth NFC Reader**. Supported smart cards types are ACOS3 and Mifare Classic^{®1}.

¹ MIFARE and MIFARE Classic are trademarks of NXP B.V.

2.0. For iOS

1. Download **ACS SmartAccess** app from **App Store**, or by clicking on the link below:
<https://itunes.apple.com/us/app/acs-smartaccess/id1142454409?mt=8>
2. Turn on the Bluetooth mode of ACR3901U-S1 or ACR1255U-J1 to make it discoverable. To do this, slide the toggle switch to the right.

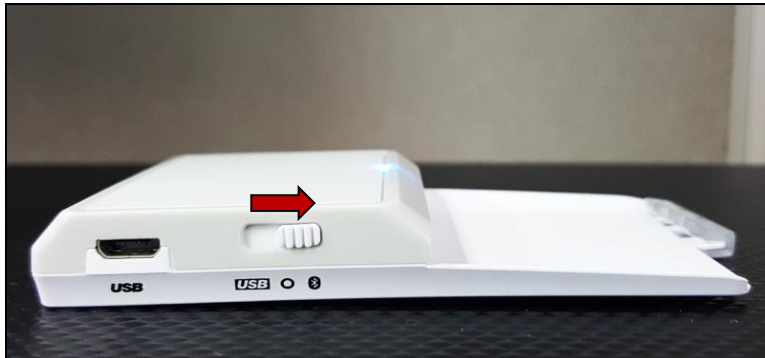

3. Turn on your device's Bluetooth by going to **Settings | Bluetooth**.
4. Open **ACS SmartAccess** app in your device.
5. Open the user guide by clicking on the button below. The guide can also be accessed by browsing the attachments.